

Example PB – S/D/M – D/S/SW –

SERIES
SINGLE/DOUBLE/EXTENSION
(PB-S, PB-D, PB-M)
OUTER DIAMETER

LENGTH
END HUB CONFIGURATION
INNER DIAMETER

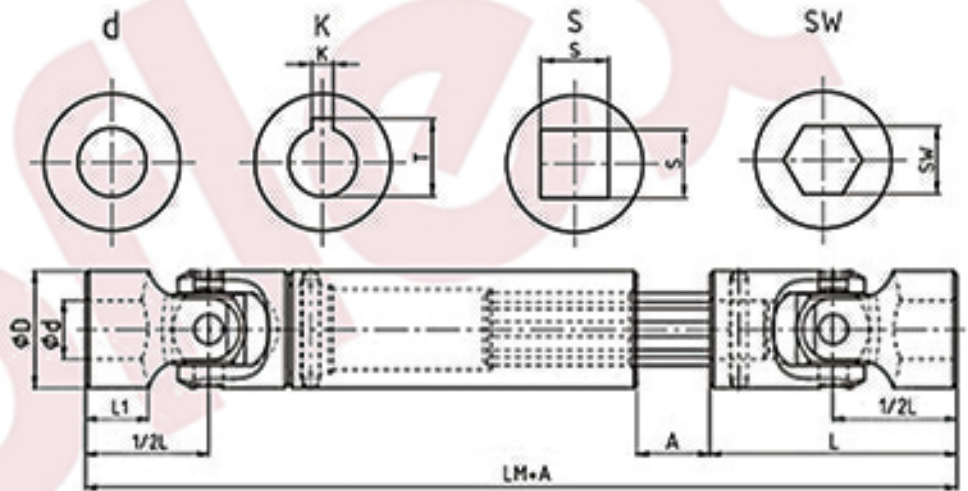

PB Series

SERIES	D	d H7	L	1/2L	L1	K JS9	T	S H11	SW H11	LD	LM+A		Allowable torque (N.M)	
											min	max	S	D
PB-13	13	6(H8)	40	20	13.5	/	/	/	/	60	130+20	200+70	4.4	3.2
PB-16	16	8	40	20	12	2	9	8	8	61.5	110+20	200+70	6	4.4
PB-20	20	10	62	22.5	12.5	3	11.4	10	10	91	120+20	200+60	11	8
PB-25	25	12	82	25	13	4	13.8	12	12	118	130+20	500+300	14	10
PB-29	29	14	90	32.5	18	5	16.3	14	14	125	155+20	500+300	30	22
PB-32	32	16	95	34	17.5	5	18.3	16	16	134	160+20	1000+450	50	37
PB-37	37	20	120	41	24	6	22.8	20	20	172	185+20	1000+450	58	43
PB-40	40	22	108	54	33	6	24.8	/	/	164	225+20	1000+210	80	58
PB-44	44	25	130	54	31.5	8	28.3	/	/	190	230+20	1000+330	100	73
PB-50	50	30	140	54	28	8	33.3	/	/	213	230+20	1000+330	140	100
PB-60	60	35	162	65	34	10	38.3	/	/	246	270+20	1000+330	185	135

• Max operating speed: 800 rpm
• Max working angle : 35°

Material Pin : GCr15 / Block : 20Cr / Yoke : 40Cr